



DRIVEWAY SERIES
D554 D560
ADJUSTABLE
BASKETBALL SYSTEM

Version 3



Installation
& Owner's
Instructions



Keep this instruction manual in case you have to contact the manufacturer for replacement parts.

SAFETY INSTRUCTIONS

FAILURE TO FOLLOW THESE WARNINGS MAY RESULT IN SERIOUS INJURY AND/OR PROPERTY DAMAGE.

FAILURE TO DO THESE SAFETY INSTRUCTIONS MAY RESULT IN SERIOUS INJURY, PROPERTY DAMAGE AND WILL VOID WARRANTY.

Owner must ensure that all players know and follow these rules for safe operation of the system.

To ensure safety, do not attempt to assemble this system without following the instructions carefully. Proper and complete assembly, use and supervision is essential for proper operation and to reduce the risk of accident or injury. A high probability of serious injury exists if this system is not installed, maintained, and operated properly.

- If use a ladder during assembly, use extreme caution.
- 4 people are recommended for this operation.
- Seat the pole sections properly (if applicable). Failure to do so could allow the pole sections to separate during play.
- Before digging, contact utility company to locate underground power cables, gas and water lines. Ensure there are no overhead power lines within 20 ft. (7 m) radius of pole location.
- Climate, corrosion or misuse could result in system failure.
- If technical assistance is required, contact us:

WARNING

FAILURE TO DO THESE WARNINGS MAY RESULT IN SERIOUS INJURY AND/OR PROPERTY DAMAGE.

Owner must ensure that all players know and follow these rules for safe operation of the system.

- Only hang from the rim briefly to regain balance or avoid injuring others.
Release the rim as soon as possible safely.
- During play, especially when performing dunk type activities, keep player's face away from the backboard, and net. Serious injury could occur if teeth/face come in contact with backboard, rim, or net.
- Do not slide, climb, or play on pole.
- When adjusting height, keep hands and fingers away from moving parts.
- Do not allow children to adjust system.
- During play, do not wear jewelry (rings, watches, necklaces, etc.) Objects may entangle in net.
- Keep water and organic material away from pole. Pole can rust and fail.
- Check pole and all metal parts regularly for rust. Completely remove rust and repaint with exterior enamel. If rust has penetrated any steel parts, replace that part immediately.
- Check system before each use for loose hardware, signs of rust and instability. Repair before each use.
- Never play on damaged equipment.
Wear a mouthguard when playing to avoid dental injuries.

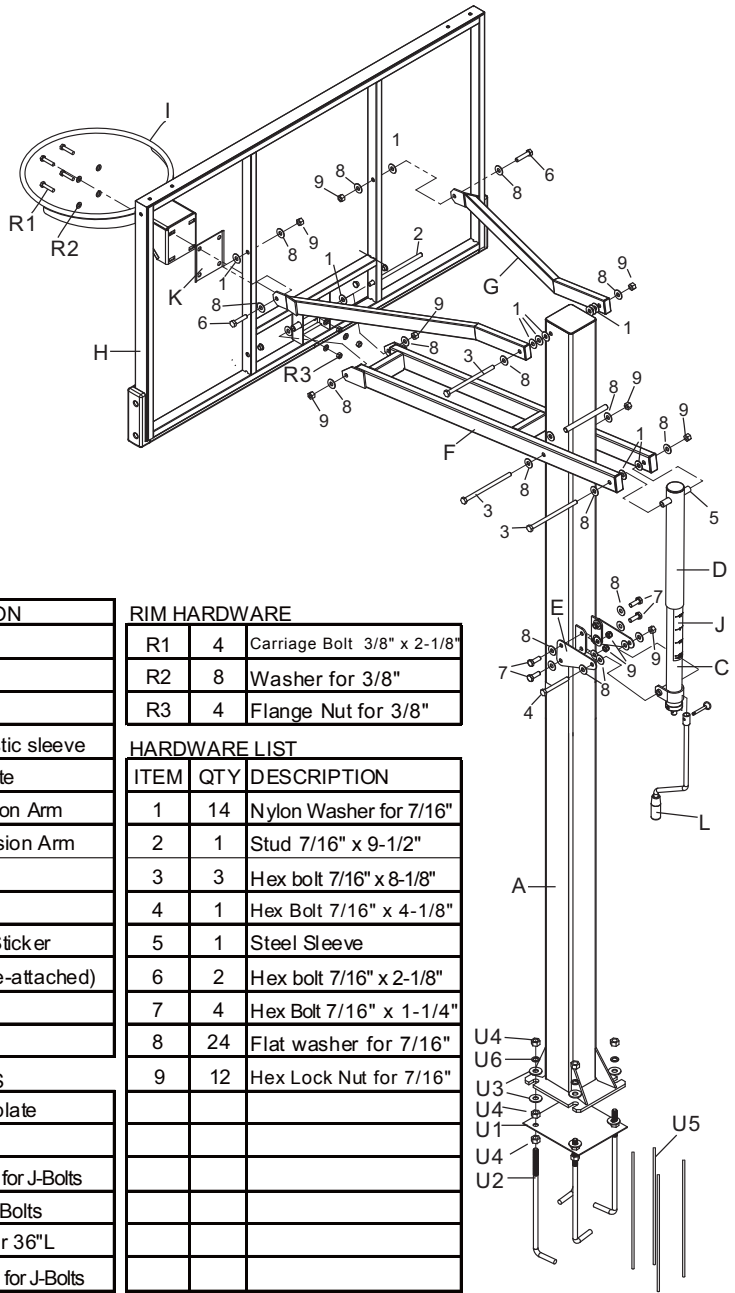

PARTS LIST

ITEM	QTY	DESCRIPTION
A	1	Main Pole
C	1	Actuator
D	1	Actuator plastic sleeve
E	2	Mounting plate
F	1	Main Extension Arm
G	2	Upper Extension Arm
H	1	Backboard
I	1	Flex rim
J	1	Rim Height Sticker
K	1	Rim Pad (Pre-attached)
L	1	Crank
M	1	Pole padding

UNDERGROUND PARTS

U1	1	Anchor Template
U2	4	J-bolts
U3	8	Thick washer for J-Bolts
U4	12	Hex nut for J-Bolts
U5	4	Anchor Rebar 36"L
U6	4	Lock Washer for J-Bolts

RIM HARDWARE

R1	4	Carriage Bolt 3/8" x 2-1/8"
R2	8	Washer for 3/8"
R3	4	Flange Nut for 3/8"

HARDWARE LIST

ITEM	QTY	DESCRIPTION
1	14	Nylon Washer for 7/16"
2	1	Stud 7/16" x 9-1/2"
3	3	Hex bolt 7/16" x 8-1/8"
4	1	Hex Bolt 7/16" x 4-1/8"
5	1	Steel Sleeve
6	2	Hex bolt 7/16" x 2-1/8"
7	4	Hex Bolt 7/16" x 1-1/4"
8	24	Flat washer for 7/16"
9	12	Hex Lock Nut for 7/16"

INSTALLATION

Prior to anchor system and goal assembly, call utility services for location of underground utility lines before you dig.

This assembly needs 3 to 5 days total.

Step 1: Anchor system installation.

Step 2: Allow concrete to cure 3 to 5 days (depending on climate region and weather).

Step 3: Complete basketball system installation.

THREE PEOPLE ARE NEEDED TO ASSEMBLE THIS UNIT

Tools and materials required for assembly

1. Hammer or Mallet
2. Two Adjustable Wrenches
3. 9/16" Wrench
4. 3/4" Wrench
5. 11/16" wrench
6. 1" Wrench
7. Shovel
8. Concrete 9 Bags (80lbs/bag).
9. Electric Drill
10. Carpenter's Level
11. A minimum of two Ladders
12. Water Supply
13. Tape measure

Step 1

Anchor system installation

NOTE: At rim height 10 foot, distance from the face of backboard to the front of Main Post (A) is 30". Use these specs to calculate desired backboard overhang of driveway/court.

1. Locate your system close to or on the court. Dig a hole as shown in figure 1. Bell out the bottom.

Assemble anchor system as shown in figure2: Thread Hex Nut (U4) all the way to bottom of threads on J-bolt (U2) insert threads of J-bolt (U2) through hole on anchor plate (U1) and secure with Hex Nut (U4).

Note: Each leg of anchor bolts should face the anchor bolt to the right. See Figure 2.

2. Mix and pour concrete into hole. follow instructions on concrete bag. Stop about 8" below playing surface.
3. Insert 4 Rebars (U5) into concrete 8" apart making a square in center on hole.
4. Continue to pour concrete into hole. Use a concrete form or wooden form for top 4", until concrete flush with playing surface.

5. Push anchor system into concrete and agitate to eliminate voids in concrete, level and square anchor plate (U1) to playing surface. Clean off any concrete on anchor plate and exposed threads.

Figure2

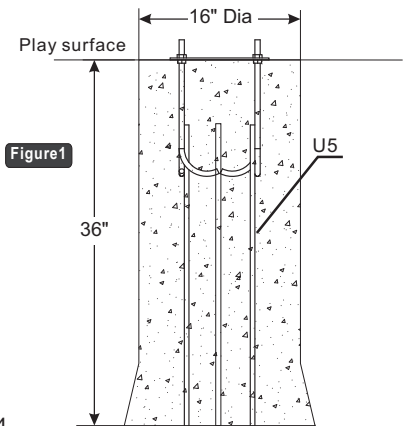
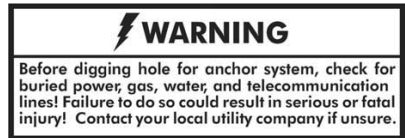
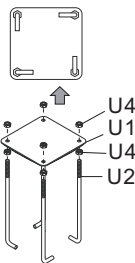

Warning
Never continue to assemble your system without following cementing instructions. Failure to do so may cause serious personal injury or property damage.

You are finished with anchor system. Allow concrete cure a minimum of 72hrs.

INSTALLATION (Step 2)

Place the Pole on the Anchor system. Slide one Thick Washer (U3) over each J-bolt (U2). Lift the Pole (A) onto Anchor system, secure with one Thick Washer (U3), one Lock Washer (U6) and one Hex Nut (U4) for each J-bolt. See **Figure 3**.

If the Main Post (A) is not exactly vertical, adjust the 16mm J-Bolt Hex Nuts (U4) located under the Post base (A). Tighten all of the Hex Nuts (U4) Above Post base when Main Post (A) is vertical.

NOTE: Face the Main Post (A&B) with Actuator Bracket facing away from playing court (as shown in FIGURE 4).

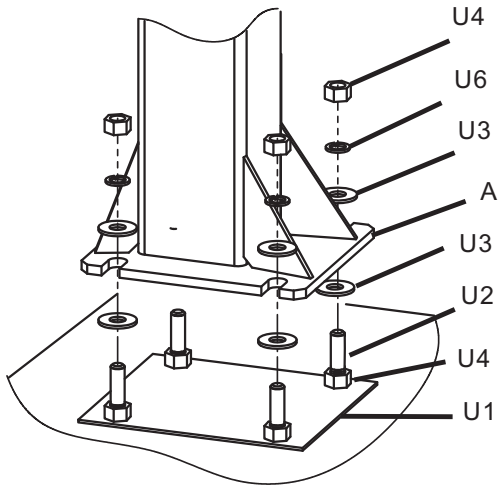

Figure 3

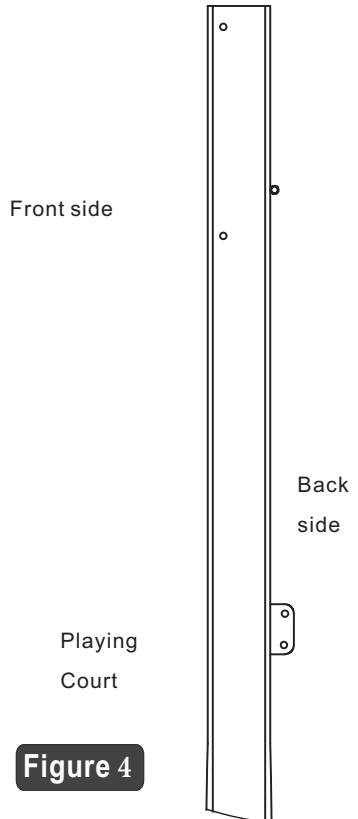

Figure 4

INSTALLATION (Step 3)

Attach Actuator mounting plate (E) to Top Pole (B).

Secure Actuator mounting plate to the bracket welded on backside of Pole (A) with 4 Hex Bolts (#7), 8 Flat washers (#8), 4 Lock Nuts (#9). See **Figure 5**. Tighten all four nuts and bolts.

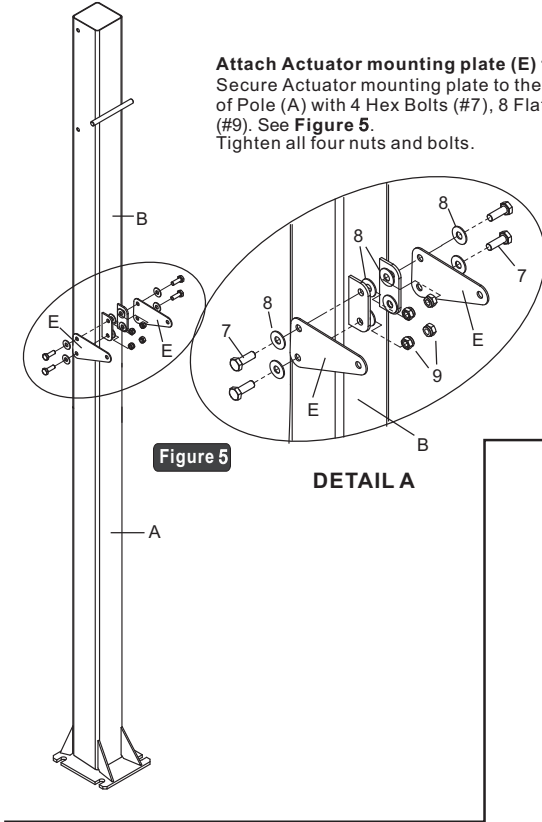

Figure 5

DETAIL A

Attach Upper Extension arm (G) to Pole (B), using one Hex Bolt (#3), two Flat Washers (#8), 6 Nylon Washers (#1), and one Lock Nut (#9). See **Figure 6**.

Note: The plastic washer should be placed between Upper extension arm (G) and Top Pole (B).

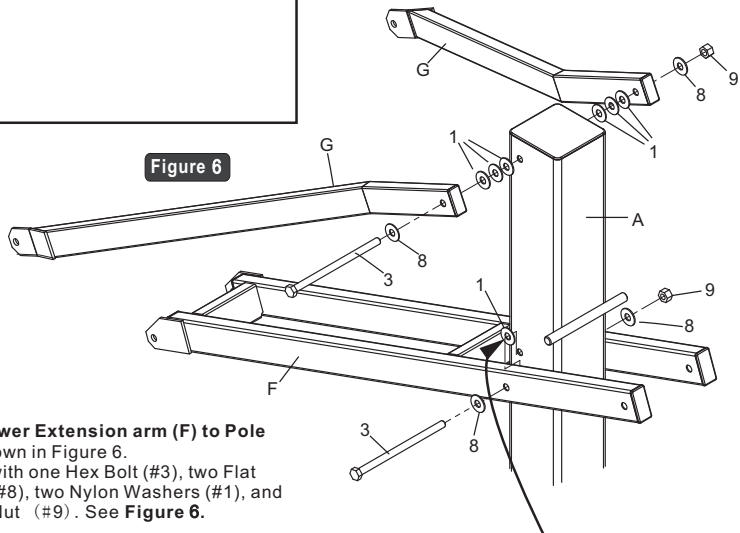

Figure 6

Attach Lower Extension arm (F) to Pole (B), as shown in Figure 6.

Secure it with one Hex Bolt (#3), two Flat Washers (#8), two Nylon Washers (#1), and one Lock Nut (#9). See **Figure 6**.

This washer has been pre-assembled in the factory.

4. Attach Actuator (C) to Lower extension Arm (F).

Slide Actuator plastic sleeve (D) over top of Actuator (C), align the hole in the Plastic sleeve with the hole in the Actuator, slide one Steel Sleeve (#5) thru both parts, see Figure 7. Hold the Actuator assembly, align Steel Sleeve with the Rear hole of Lower extension Arm (F), Attached them together with one Hex Bolt (#3), two Flat Washers (#8), two Nylon Washers (#1) and one Lock Nut (#9). Do not over tighten the bolts.

Figure 7

Slide Plastic sleeve over Actuator

STEP 4

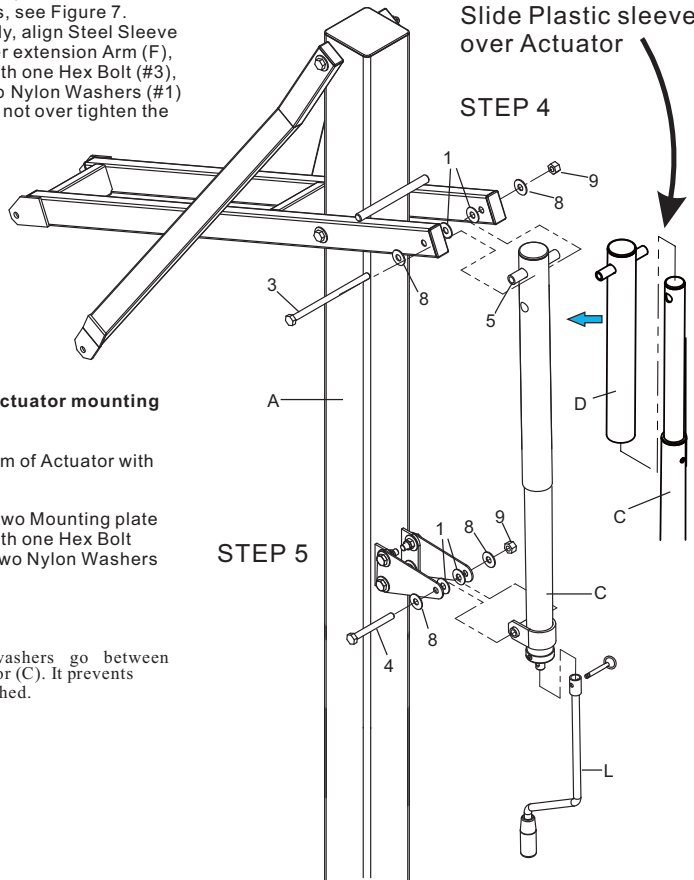

5. Attached Actuator (C) to Actuator mounting plate (E). See Figure 7

Attach Crank (L) to the bottom of Actuator with supplied Lock pin.

Crank Actuator in between two Mounting plate (E), secure them together with one Hex Bolt (#4), two Flat Washer (#8), two Nylon Washers (#1), and one Lock Nut (#9).

Do not over tighten this bolt.

Note: Make sure Plastic washers go between Mounting plate (E) and Actuator (C). It prevents painted parts from being scratched.

STEP 5

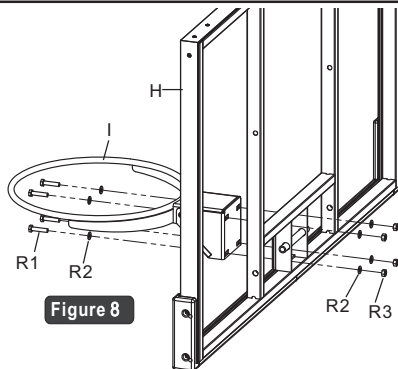
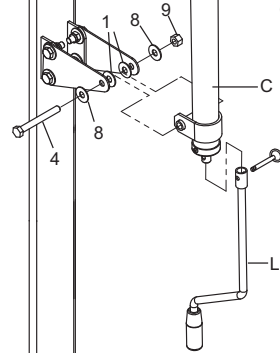

Figure 8

6. Attach Goal (I) to Backboard (H).

Remove the Rim box cover, put Goal against Rim pad (Pre-installed), secure it with 4 Carriage Bolts (R1), 8 Flat Washers (R2), 4 Flange Nuts (R3) See Figure 8.

Tighten all four bolts and nuts.

Put Rim box cover back and secure it with removed screws.

Figure 9

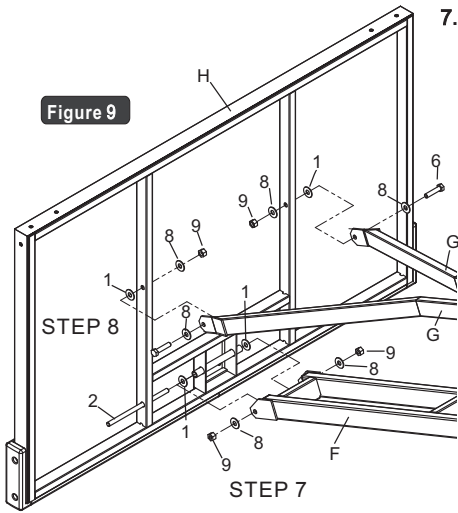

7. Attach Backboard (H) to Lower Extension arm (F).

Turn crank to lower support frame (F) until against safety stop rod welded on the back of Top Pole (B).

With 3 capable adults, raise the Backboard and rim assembly up and connect Lower Extension arm (F) to the Backboard Bracket using one Stud (#2), 2 Washers (#8), 2 Plastic Washers (#1), and 2 Lock Nuts (#9).

Tighten this bolt snugly. See Figure 9.

Note:

1. Slide the Stud thru from outside of Vertical tubes. After the stud is installed, plug end caps into the holes on the vertical frame, to keep bees from holes. 4pcs plugs can be found in the hardware pack or manual pack.
2. The plastic washer goes between backboard bracket (H) and Lower extension arm (F).

8. Attach Backboard (H) to Upper Extension arm (G).

Connect Upper board arm (G) to the Backboard vertical frame (H) using 2 Hex Bolts (#6), 4 Flat Washers (#8), 2 Plastic Washers (#1), and two Lock Nuts (#9).

Tighten the two bolts and nuts snugly.

See Figure 9.

Note: The plastic washer goes between backboard vertical frame (H) and Upper extension arm (G).

9. Apply Rim Height Sticker

Use a tape measure to crank rim up to exactly 10' from playing surface. Make a line mark on the Actuator (C) against bottom edge of Actuator Sleeve (D).

Crank the rim all the way down to the extreme end. Peel and apply Rim Height sticker (J) to outside of Actuator (C) lining up the mark with the 10' mark on the Rim Height Sticker.

See Detail B.

Apply Pole pad if available.

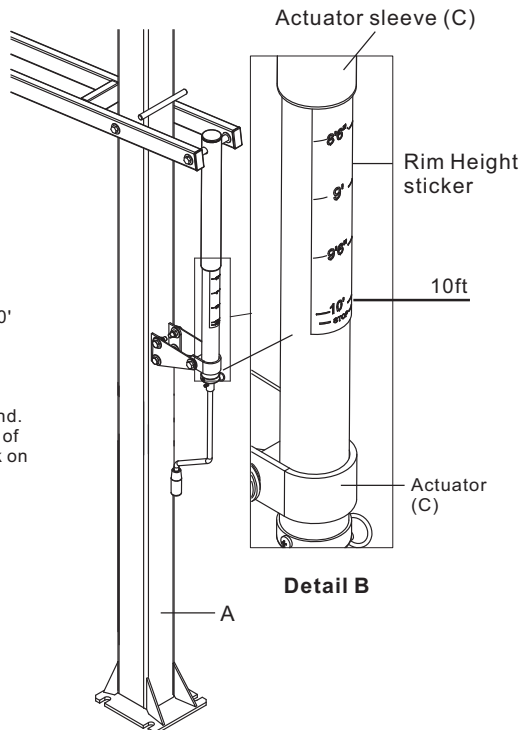

Ryval Warranties

Buyer agrees that products sold by Ryval hoops carry the following warranty. Subject to proper installation and normal, intended use, all structural components of Coach Series tm, Phenom X Series tm, Wall Mount Hoops are warranted to the original owner to be free of defects in materials and workmanship for the duration of ownership (Limited Lifetime) by the original retail purchaser, subject to the limitations below. The Driveway Series tm will be covered by this warranty for a period of 5 years. This limited warranty coverage is extended only to the original retail purchaser and terminates if the original retail purchaser otherwise transfers or sells the product. This warranty is limited to a repair or replacement of the defective part. Product covered under this warranty will be shipped at the customer's expense. Ryval Hoops is not responsible for any expense associated with freight, or delivery and installation of the warranted part(s). Ryval Hoops reserves the right to inspect all warranty claim parts for which a claim has been made.

Any modification could damage the structural integrity of the equipment and voids all warranties. Where listed as "Limited", the warranties shall cover damage or failure that occurs during the course of normal or intended use of the product. Normal or intended use shall be described as activity that is necessary for the participation in the sport for which the equipment is designed. Not covered is damage caused by deliberate hanging, multiple player hanging, vandalism, non-basketball activities or any other activity that could be regarded as abusive.

Padding Warranty: Multi-Purpose Backboard Edge Padding: One-year limited warranty.
Custom fit & Wrap around Pole Padding & Gusset Padding One-year limited warranty.

Net: One-year limited warranty

Not Covered By This Warranty

- Any Products subjected to abuse, negligence, improper installation, vandalism, acts of God, alteration of product or any other events beyond the control of Ryval Hoops.
- Use in non-residential applications of glass backboards.
- Paint or rusted parts. If rust begins, sand rust & loose paint, primer & paint with a satin black. Touch-up kits are available.
- Deterioration of product due to time or wear and tear.
- Use in non-residential applications of Glass backboards.

Normal deterioration of products due to atmospheric conditions, weather, rust wear and tear (including paint), or other causes that do not affect functional use are not covered by Ryval Hoops warranties. All warranties are valid only when product is used in the intended application and when installed according to Ryval Hoops instructions. Warranty will be void if maintenance instructions in the owner's manual are not followed, including jack lubrication. If you did not receive an owner's/instruction manual, please contact Ryval Hoops and one will be sent to you.

Warranty Claims: A copy of the original invoice must be presented to initiate warranty claim. A warranty claim form must be completed and photos submitted for any item you wish to claim under warranty. If part to be warranty is requested, a "Return Merchandise Authorization" (RMA) number will be required prior to shipping damaged Product by original retail Consumer Purchaser with freight prepaid by consumer. If the purchase was made through a dealer, warranties do not cover dealer service charges, labor charges, freight or travel expense associated with replacement, repair or removal or warranty item

-This warranty is exclusive and expressly in lieu of all other warranties, expressed or implied, including warranties of merchantability or fitness for use. Ryval Hoops does not assume, or authorize any person to assume for us, any other liability in connection with the sale of our products. If Ryval Hoops cannot disclaim or exclude implied warranties under applicable law, then to the extent possible any claims under such implied warranties shall expire or expiration or the applicable warranty period. Some states do not allow limitations on how long an implied warranty lasts, so the above limitation may not apply to you, Ryval Hoops does not assume or authorize any person to assume for us, any other liability in connection with the sale of our products. Ryval Hoops shall not be liable for loss of use of the product or other consequential or incidental costs. Expenses or damages incurred by the consumer or any other use.

To the maximum extent permitted by law, Ryval Hoops assumes no responsibility for incidental or consequential damages, which may arise from the purchasers or use of our equipment. Some states don not allow the exclusion or limitations of incidental or consequential damage, so the limitation or exclusion may not apply to you. If any provision of this warranty is invalid, void or unenforceable in any instance or respect, the unenforceable provision will be severed and reformed to affect the intent of this limited warranty to the maximum extent possible, and the remaining provisions shall continue in full force and effect and shall be enforced to the full extent permitted by law.

Ryval Hoops reserves the right at any time to change product specifications or substitute similar components. A limited lifetime warranty is effective for the duration of ownership by the original retail purchaser or 5 years after discontinuation of the product by Ryval Hoops.

This warranty gives you specific rights and you may also have other rights, which vary from state to state.

Questions or Comments?

www.RyvalHoops.com

Email: info@ryvalhoops.com

Phone 800-787-0655